

*Beautiful parkland setting*

# HOSPITALITY



*Event spaces  
designed for  
hosting*



*Light and airy hospitality rooms give out on to balconies, cricket, tennis and Capability Brown parkland beyond.*

## Lake Room

TYPE		CAPACITY		
Stand up reception		110		
Conference		70		
Dinner		90		
Dinner/Dance		75		
HIRE	½ DAY	FULL DAY	EVENING	
Public	£600	£600	£1200	
Members	£300	£300	£600	



## Garden Room

TYPE		CAPACITY		
Stand up reception		75		
Conference		60		
Dinner		30		
Buffet		50		
HIRE	½ DAY	FULL DAY	EVENING	
Public	£300	£300	£600	
Members	£150	£150	£300	



## Lounge

TYPE		CAPACITY		
Stand up reception		60		
Buffet		50		
HIRE	½ DAY	FULL DAY	EVENING	
Public	POA			
Members				



## Dining Room

TYPE		CAPACITY		
Stand up reception		48		
Boardroom		36		
Conference		48		
Dinner/Dance		48		
HIRE	½ DAY	FULL DAY	EVENING	
Public	POA			
Members				



# Room SERVICE

## *Extras to make your event special*

- Inhouse chefs
- Well stocked and staffed bar
- Live music licence to 12.30am
- Inhouse tables and seating availability
- Scullery kitchen with fridge and sink
- PA system
- Parking by arrangement

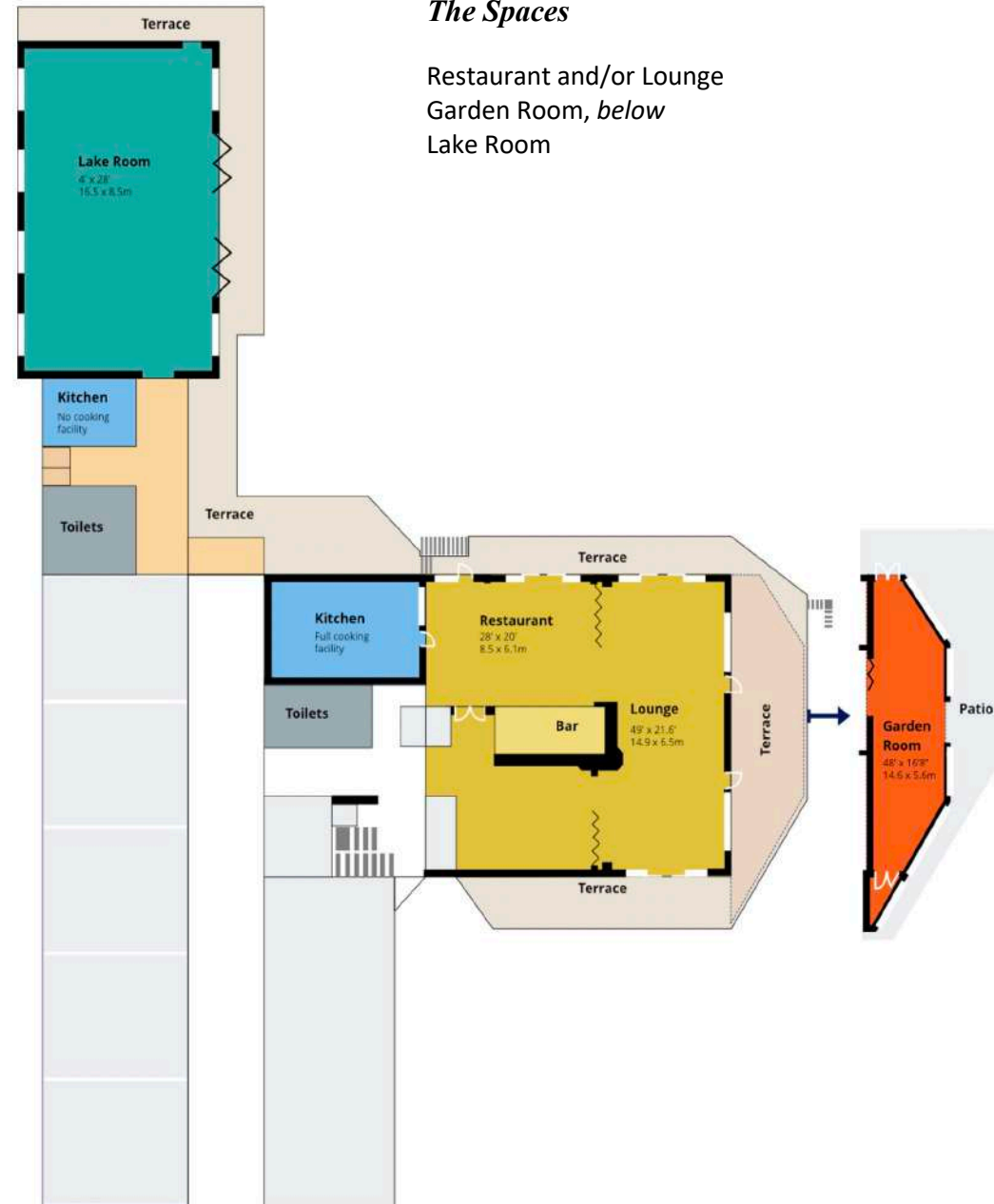

## *The Spaces*

- Restaurant and/or Lounge
- Garden Room, below
- Lake Room



## *A special venue*

# THE WIMBLEDON CLUB

Floor to ceiling windows, balconies and modern purpose built spacious rooms combined with the famous parkland setting make this venue a breath of fresh air on the London scene.

Spaces work well for many uses as well as the graceful grandeur of more formal occasions. Children's parties, discos, work events, launches, exhibitions, fundraisers, classes and bridge are among the regulars.



## *About*

The club is one of the biggest community sports centres in the area and a venue for VIP hospitality and world class events in the sporting year.

As well as the clubhouse, the nine acre site has a cricket pitch, 16 tennis courts, five squash courts and parking. Hockey pitches are offsite.

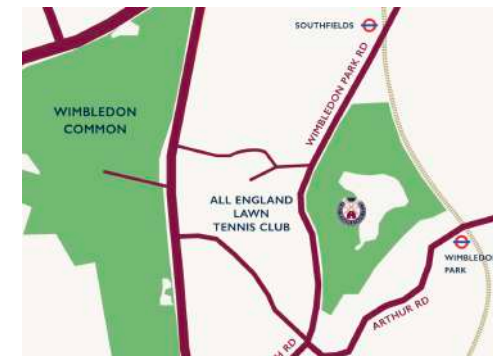

**The Wimbledon Club**  
Church Road, LONDON SW19 5AL

(+44) 20 8971 8089  
[hospitality@twcsport.co.uk](mailto:hospitality@twcsport.co.uk)  
[www.twcsport.co.uk/hospitality](http://www.twcsport.co.uk/hospitality)

